

WBC Active Travel update

Farnham Cycle Campaign AGM,
5th June 2023

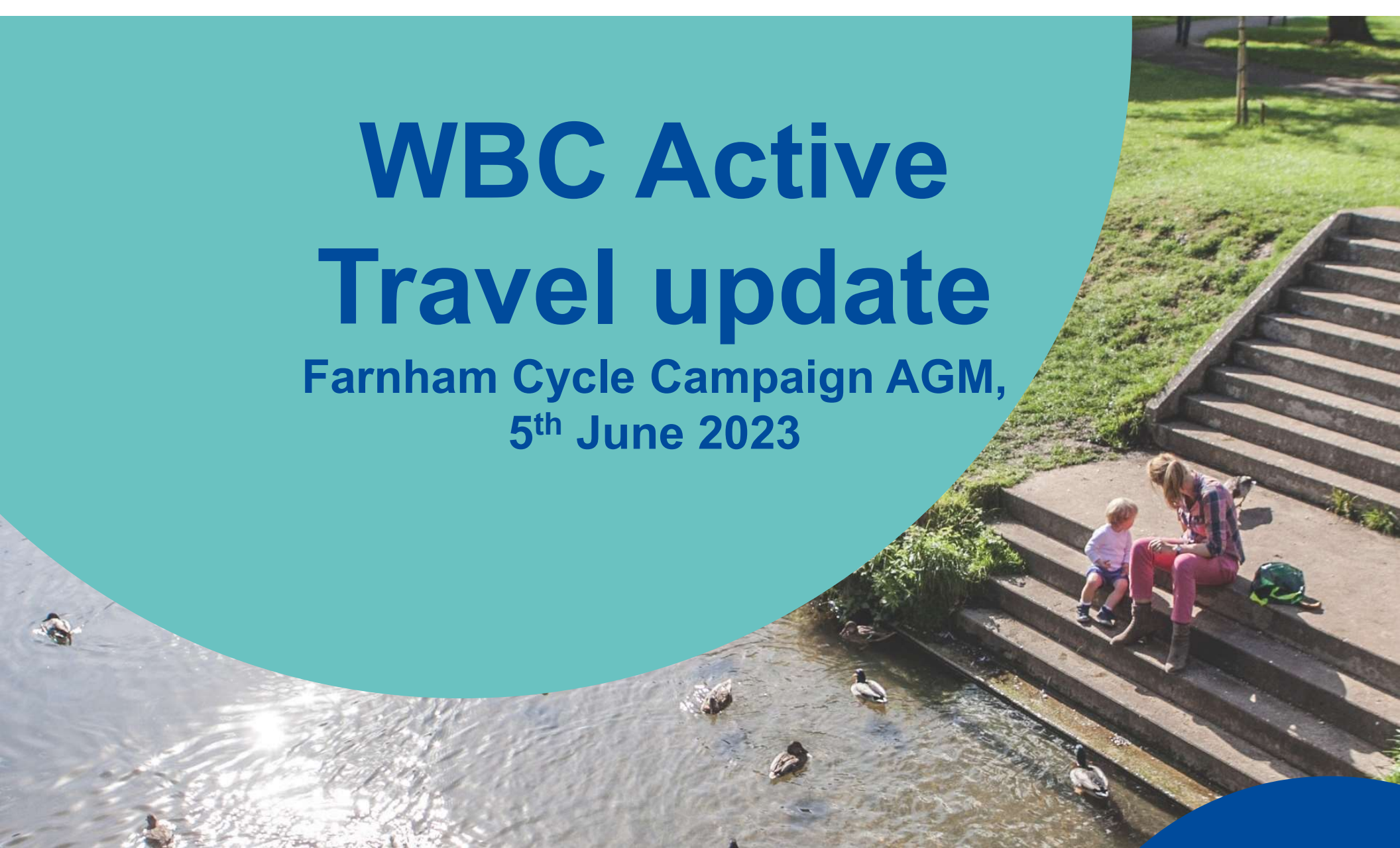

Context

Waverley Borough Council's Carbon Neutrality Action Plan

"We're the first generation to feel the impact of climate change and the last generation that can do something about it."

Washington Governor, Jay Inslee (2014)

Context

Waverley Borough Council's Carbon Neutrality Action Plan

In September 2019, Waverley Borough Council passed a motion declaring a climate emergency and committing the council to become a carbon neutral council by 2030*

*1% of carbon emissions across the borough are directly from Waverley Borough Council activities and services

Context

Waverley Borough Council's Carbon Neutrality Action Plan

Beyond the council's own emissions:

- Travel and transport are responsible for 46% of Surrey's carbon emissions[‡]
- Around 66% of this is due to car usage*

[‡]Surrey Climate Change Strategy (2020)

*Surrey Climate Commission's Carbon Baseline Study, Erica Russell with Ian Christie, Richard Murphy, Centre for Environment & Sustainability, University of Surrey (2021)

What is sustainability?

“The ability to be maintained at a certain rate or level”



Waverley and sustainable transport

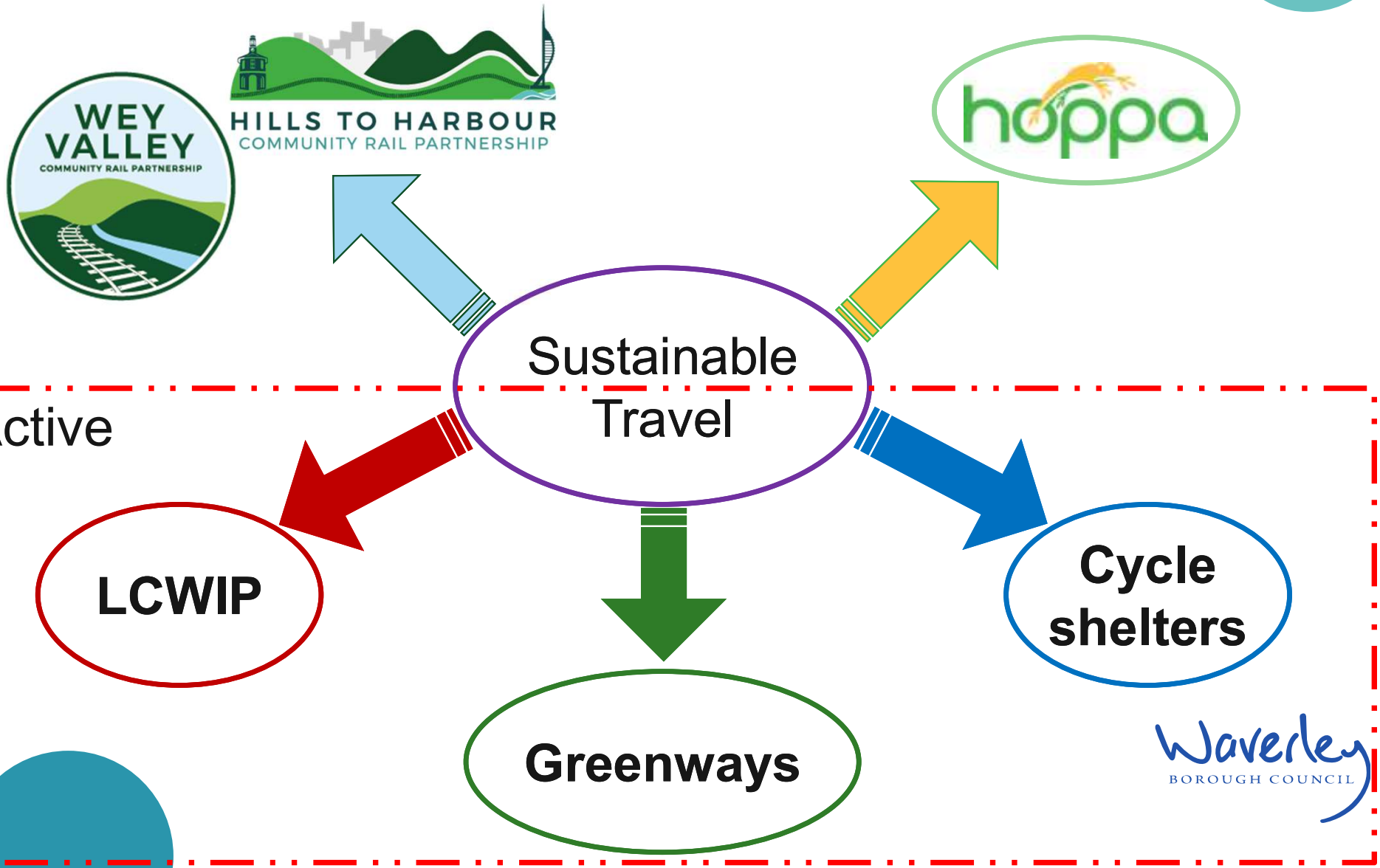

Active travel: what is that?

- Walking
- Cycling
- Wheelchairs and mobility scooters
- But is even more inclusive!
 - running,
 - kick scooting,
 - skateboarding,
 - roller-skating,
 - rollerblading,
 -

Greenways

- Guildford – Godalming: SCC led, in design
- Godalming Gateway: WBC led, in design
- Hale Trail: major project for WBC Greenspaces team
- Scholars: improvements via planning (WBC) and FIP (SCC)
- Weyside: WBC supporting SCC for section from Riverside to South St section

Cycle shelters



Crown Court, Godalming

High Street car park, Haslemere



Village Way, Cranleigh



Local Cycle and Walking: where to build the infrastructure?

- Where it is easy to build?
- Where there is already walking & cycling?
- Where there is the most *potential*?



LCWIP: programme

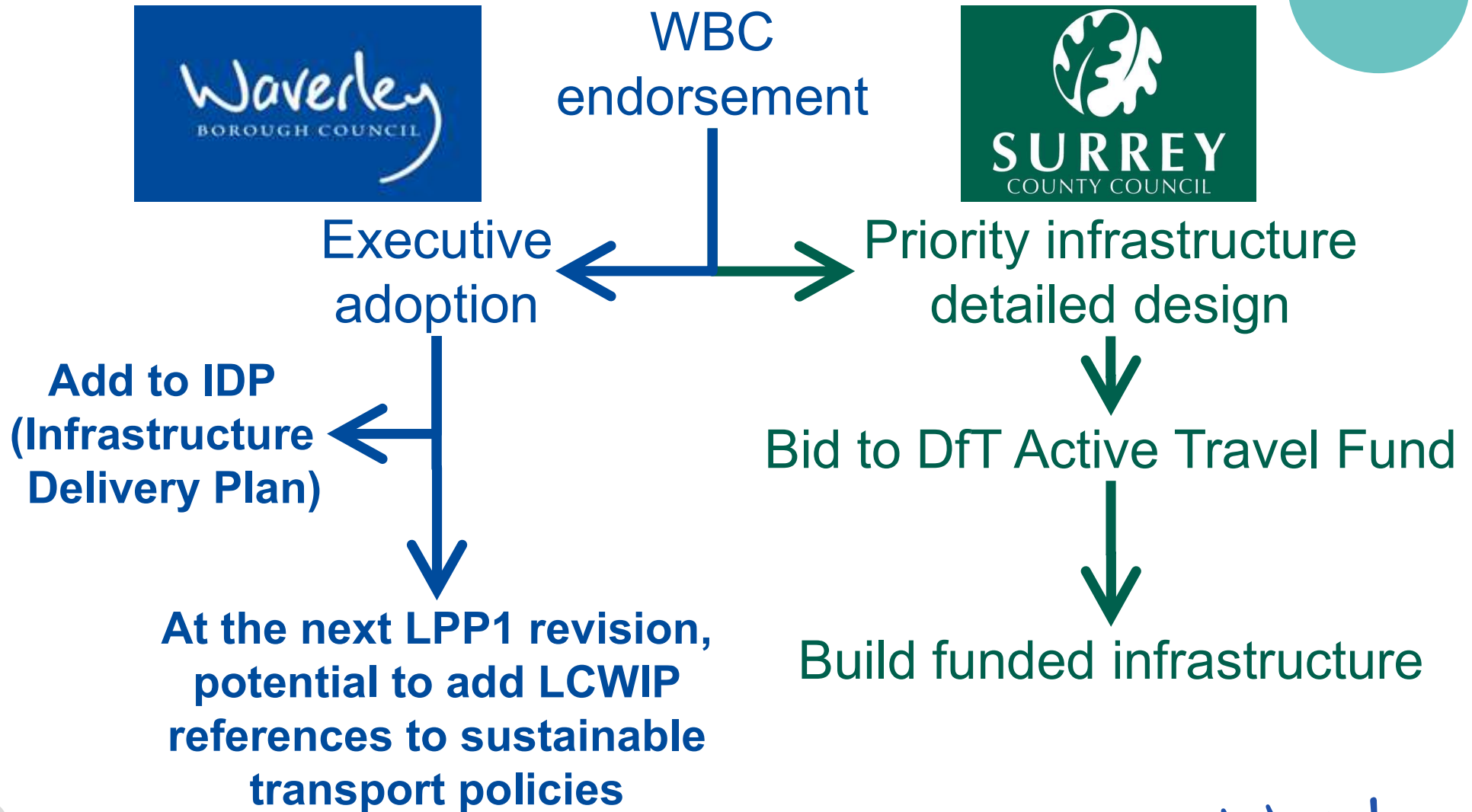

Opportunity lost...

Premier Inn development



Opportunity lost...

Premier Inn development



Opportunity created...

Hawthorns planning application (2021)



2m wide footway

Drop kerbs, pedestrian crossing point

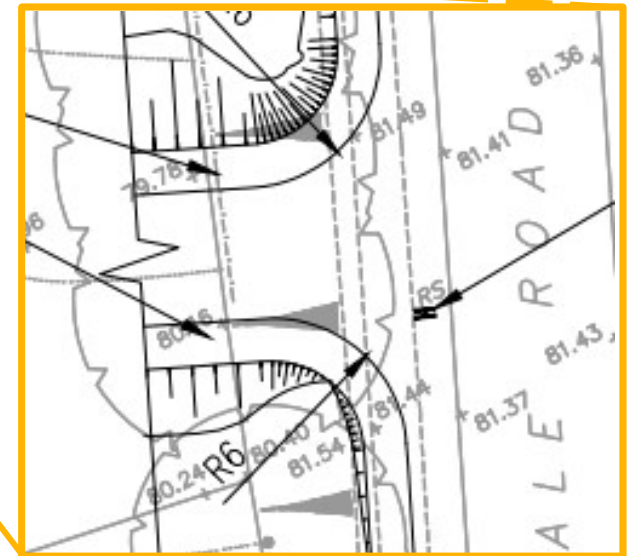

Opportunity created...

Hawthorns planning application (2022)

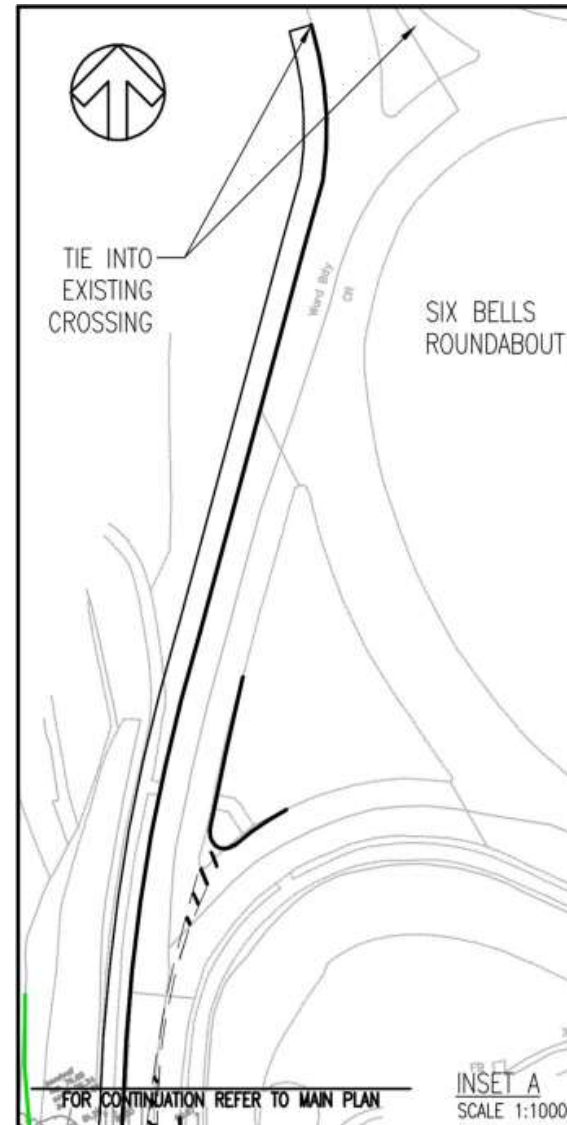
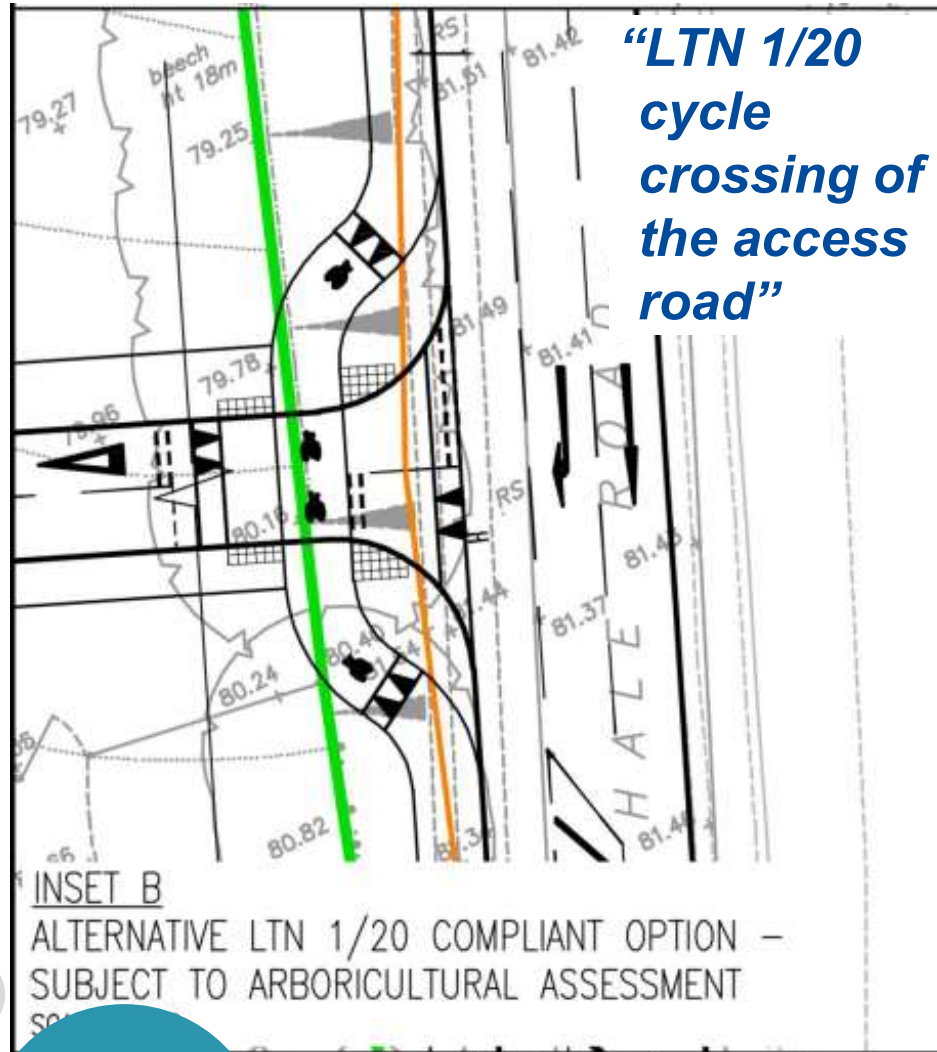

**3m wide
shared use
path: 6 Bells
roundabout
to pub**



Waverley
BOROUGH COUNCIL